

## Instructions

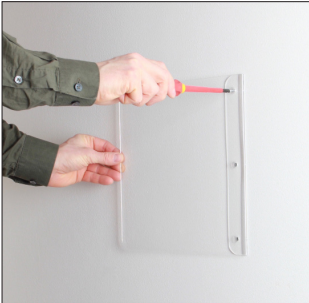

Decide where you want to hang the display. If necessary, use a level. Drill with a 5mm drill holes in the wall for the plugs. Place the plugs into the holes. Position the short side of the display against the wall and screw the screws in the plugs with a screwdriver.



Do not use an electric screwdriver as it could potentially damage the display.



Slide the cover over the display. Place your hand at the back of the cover and gently slide the cover over the display. Do not worry about bending the display; it will not break easily.



If you decide to leave the vinyl inside the cover: Make sure that the vinyl is in front of the display.

### Good to know:

The plugs are suitable for a stone wall. Decide if the wall is suitable for the plugs.

Please consult a professional for further instructions.

Do not over tighten the screws. Small cracks around the display may occur, however, as this is a common characteristic of Perspex, this will not have any effect on the stability of the display.

Due to the production process, the product may appear to be slightly warped. This is normal and will not be visible after installation.